

Fiskars® Squeeze Punch

- A revolutionary punch technique!
- Comes in 3 sizes: M (1"- 2.5cm) L (1.5"- 3.8cm) X L (2"- 5cm)
- Extremely easy to use with clear visibility at where you punch.
- Ideal for creating cards and decorating Scrapbook pages
- Maximum material thickness: **300g. 210g recommended**

1. Features

By keeping the shape always visible, it is easier for you to get the right positioning right and see where you are punching.
The punch gives you a clean and precise cut, with effortless ease.



The side handles make it very easy to use with very little force being needed for punching (about 5 to 7 times less effort than any other punch on the market).

The cut out shapes will come in handy for decorating your projects.



2. Handling the Squeeze Punch

Hold the Squeeze Punch in your hand and insert the paper into the slot provided. Apply pressure to cut out your shape.

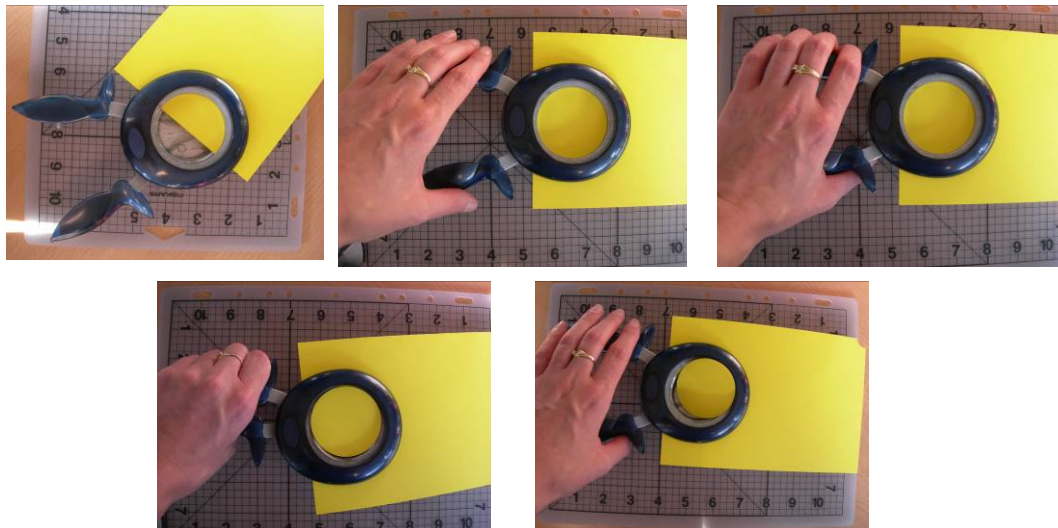

Up side down punch:

You notice that it's actually up side down when compared to the punches you may have used in the past.

Instead of looking at over, we already have done that part for you.

When punching, you can actually align the design in your pattern paper with your punch to create a simple embellishment or design.



The quality and design of your Fiskars® tool allows you to work with a wide range of materials: paper, adhesives, plastic, photos, vinyl, fine metal, etc... Try mixing different shapes and materials in your creations.

Stackable patterns:

Thanks to 3-sized punches, you can create stackable patterns: even mixing them or assembling the same one in different sizes.

It enables you to create quickly and very easily different shapes.



Storage:

The different punches can be stacked one on top of the other for easier, clutter-free storage.



Gluing techniques:

Place the applicator of the glue pen over what you have to attach. Put a drop of glue on the back of the cut out shape. Be careful not to use too much glue.

Another way to decorate your projects is to use reversible adhesive squares (available in a variety of formats) when gluing your confetti. There is a very simple technique for doing this: stick adhesive paper to the back of your paper before punching out the shapes. Once you have punched out the shapes, simply remove the protective film then apply your shape onto your creation.

3. Practical advice

To align your shapes in a straight line, measure the space required between each shape. Using a pencil, lightly mark the reverse side of your medium where you want the shapes to be created.



When you have aligned the markings with the centre of the Fiskars® Squeeze Punch, with the pattern facing up for clearer visibility, cut out your shapes.

To sharpen the blades of your Squeeze Punch, repeatedly punch through sand paper (as used by builders), choosing one with very fine grain, so as not to damage your Fiskars® tool.



To oil the blades of your Squeeze Punch, make repeated perforations in vellum paper (as used in the kitchen). This helps “oil” and preserve the life of your cutting tool.

Store your Squeeze punch in a dry place, to prevent it from rusting.
